

Rozmieszczenie dźwigarów Skala 1:100

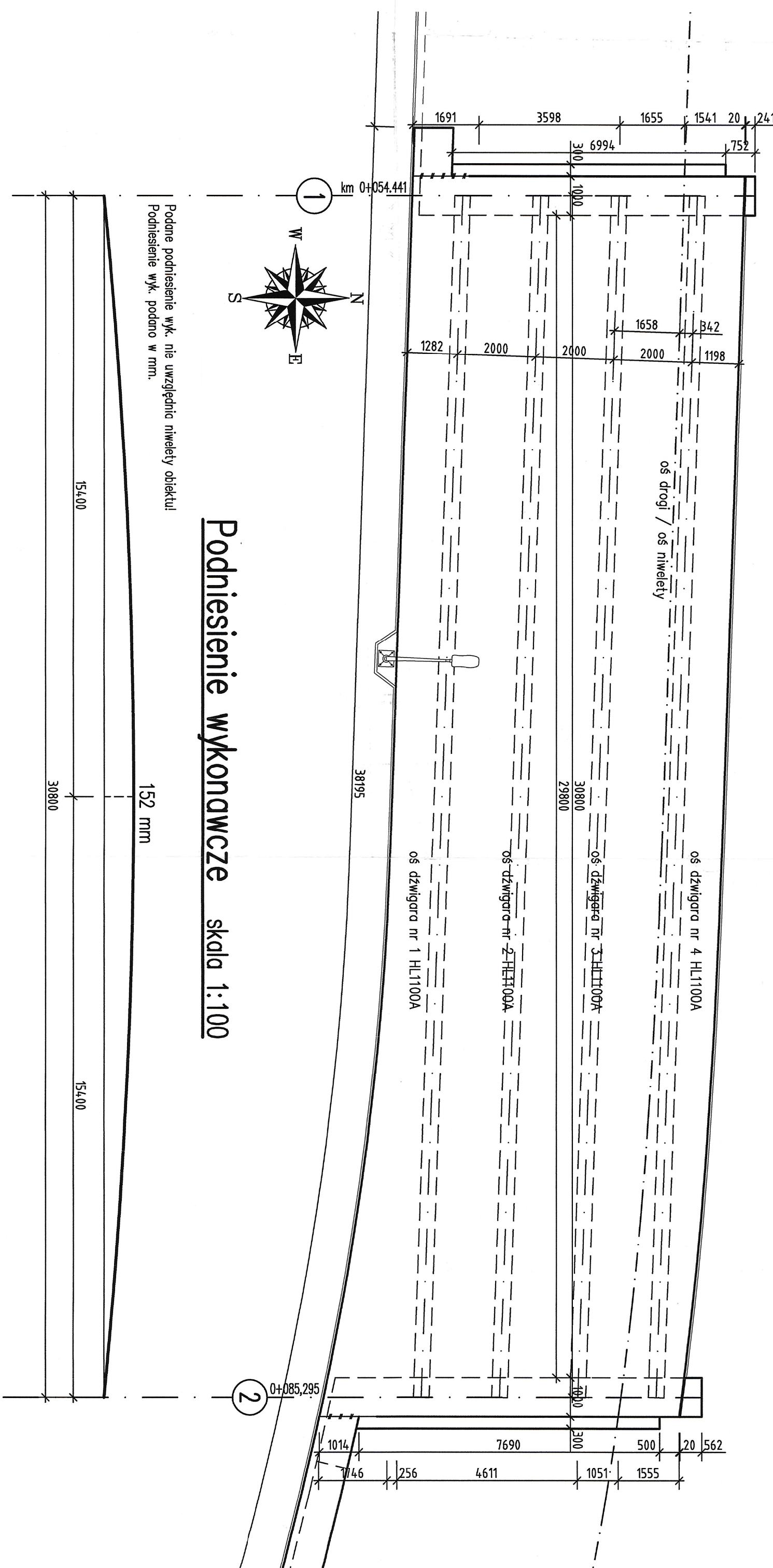

Oznaczenie dźwigarów

w przekroju poprzecznym Skala 1:50

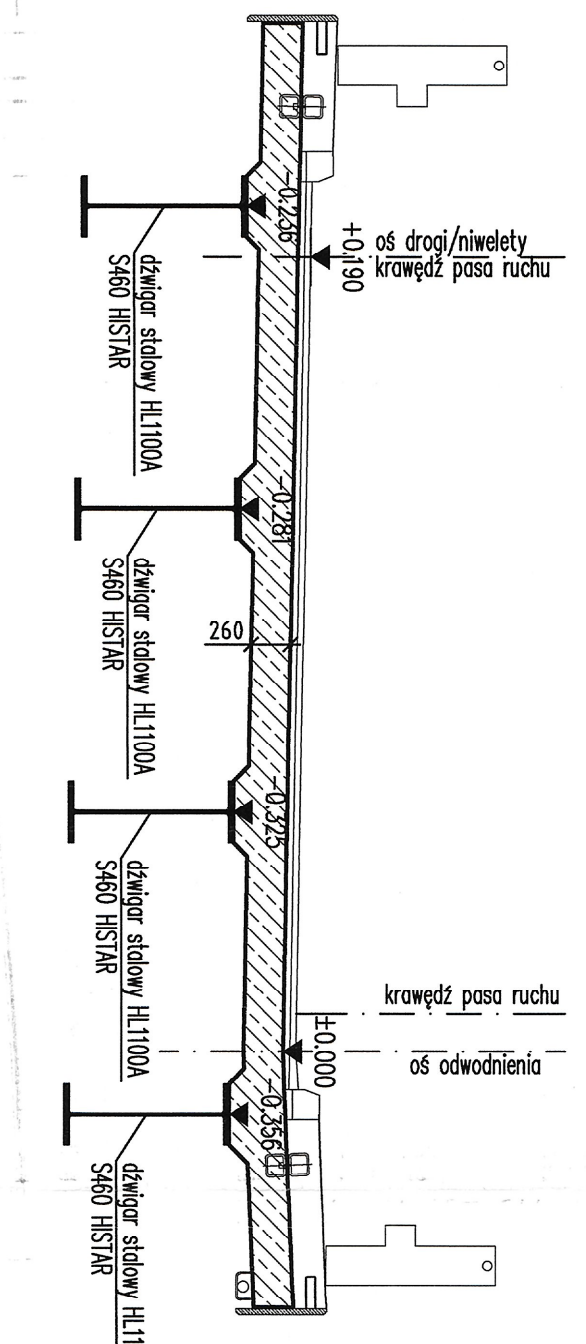

Przekrój A-A Skala 1:20

Profil HL1100A

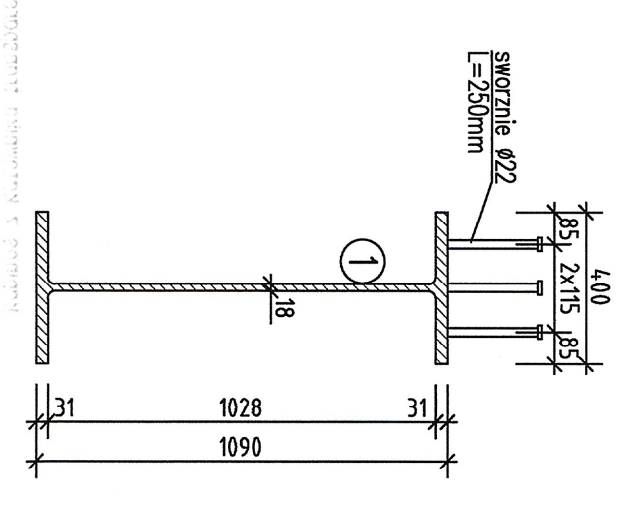

Zakończenie belek Skala 1:20

Profil HL1100A

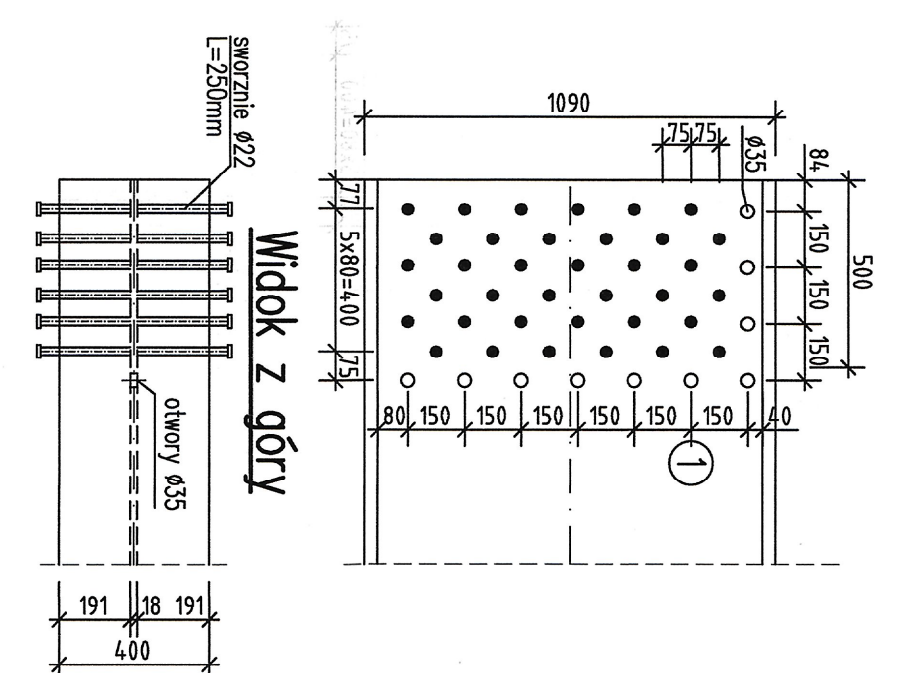

Widok W1 Skala 1:15

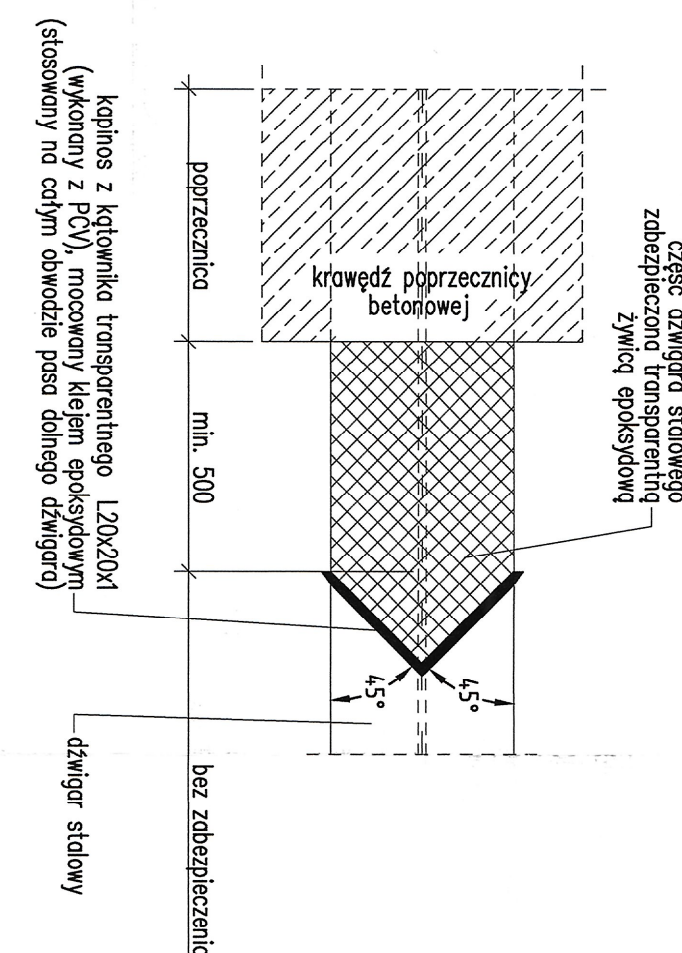

Widok z boku Skala 1:20

E

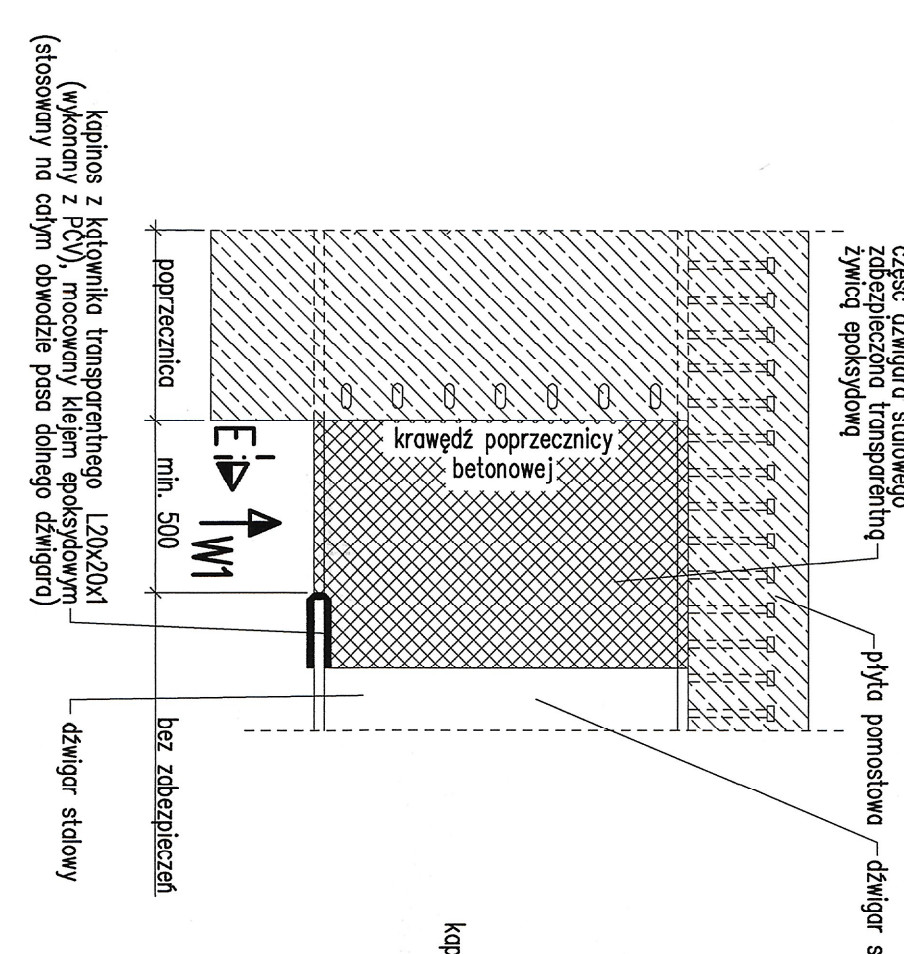

Przekrój E-E Skala 1:20

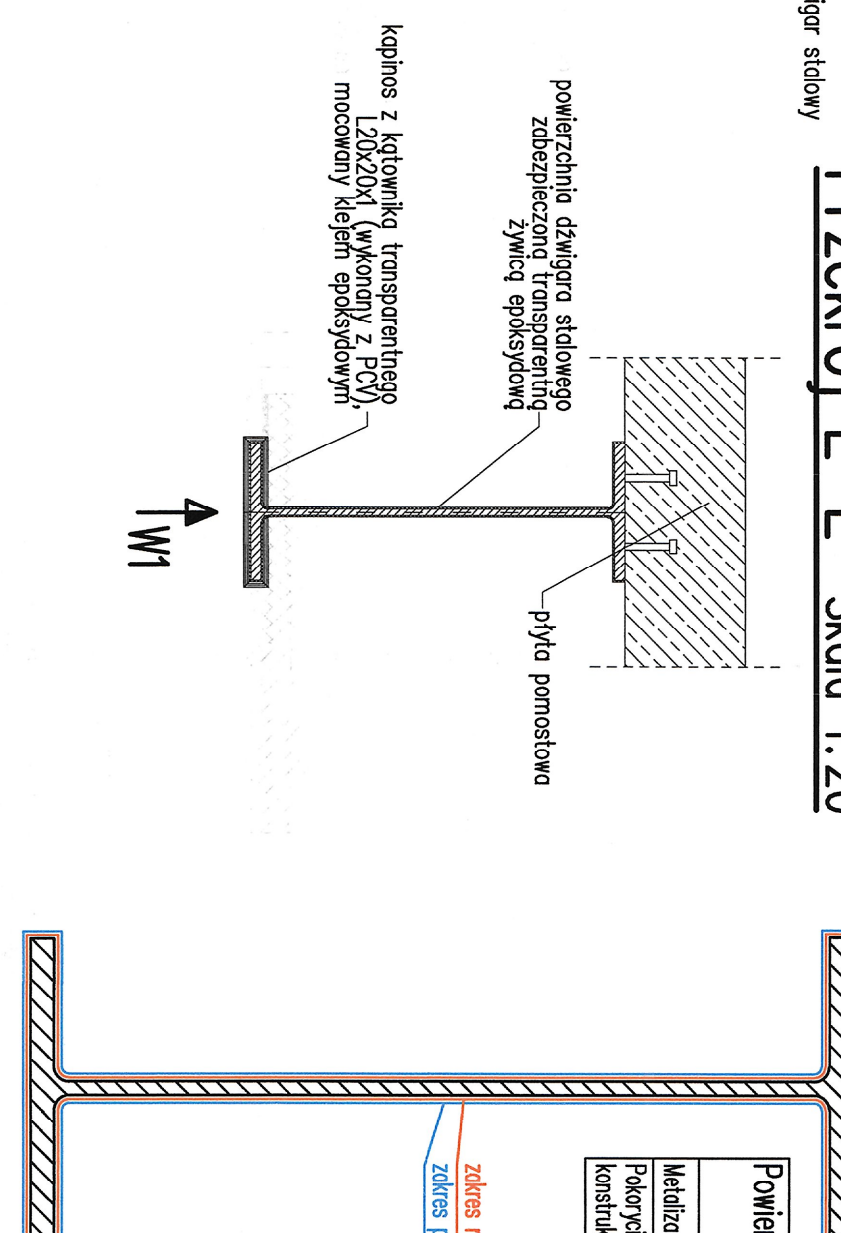

Zabezpieczenie antykorozyjne skala 1:10

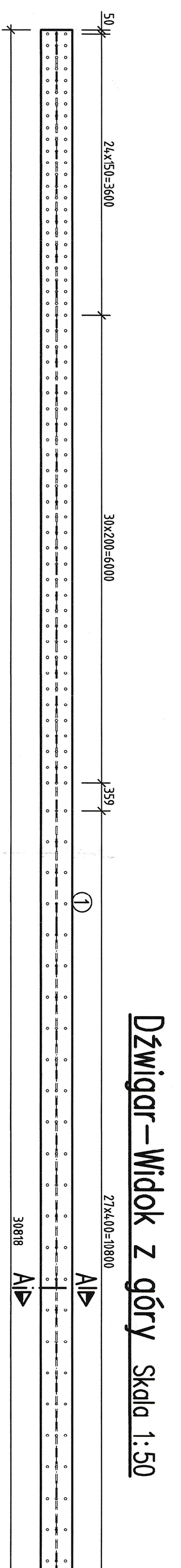
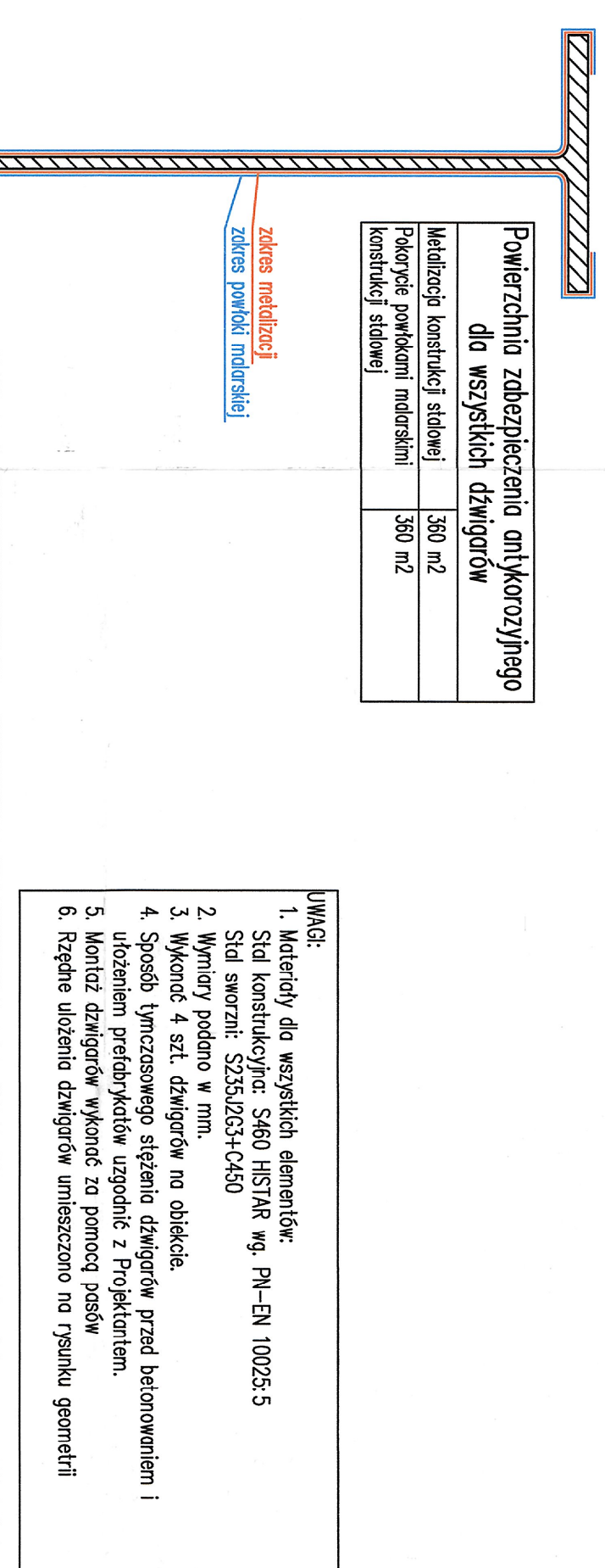

Dźwigar-Widok z góry Skala 1:50

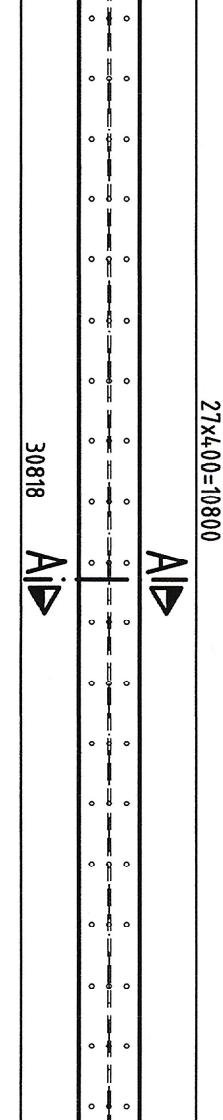

Dźwigar-Widok z boku Skala 1:50

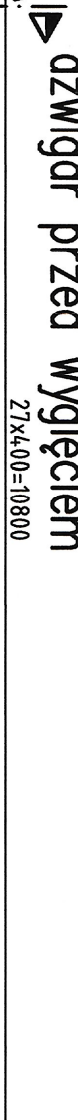

Dźwigar I -Widok z boku Skala 1:50

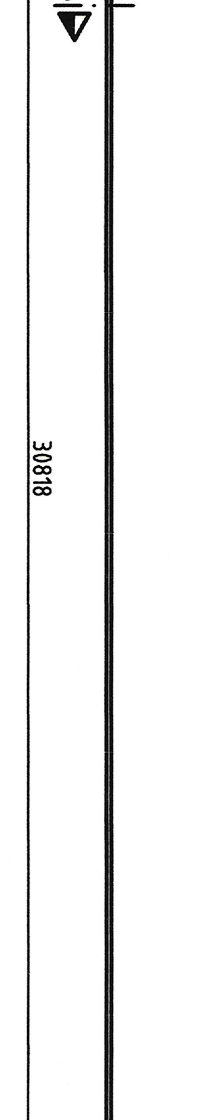

Dźwigar po wyjęciu - bez strzałki podniesienia

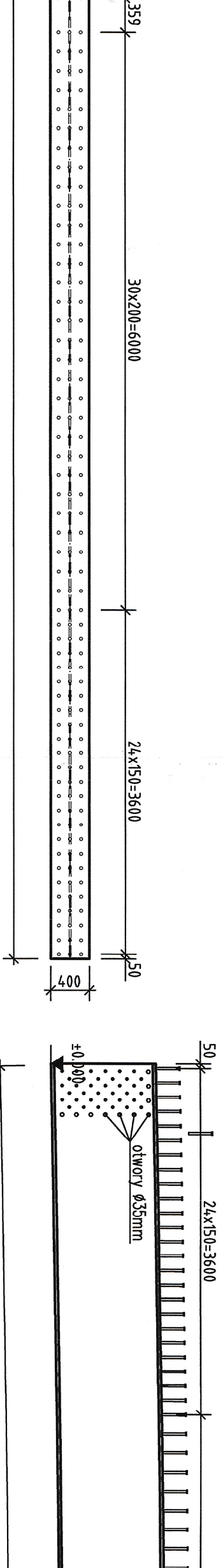
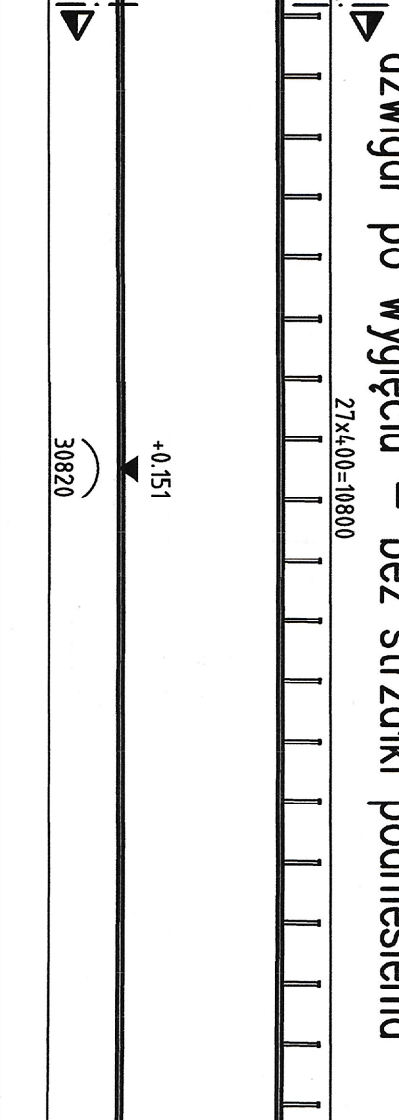

Dźwigar II -Widok z boku Skala 1:50

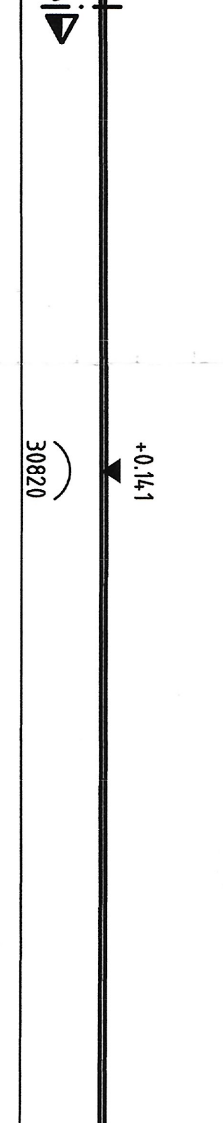

Dźwigar III -Widok z boku Skala 1:50

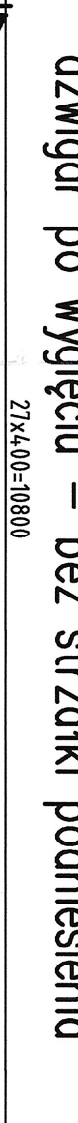

Dźwigar IV -Widok z boku Skala 1:50

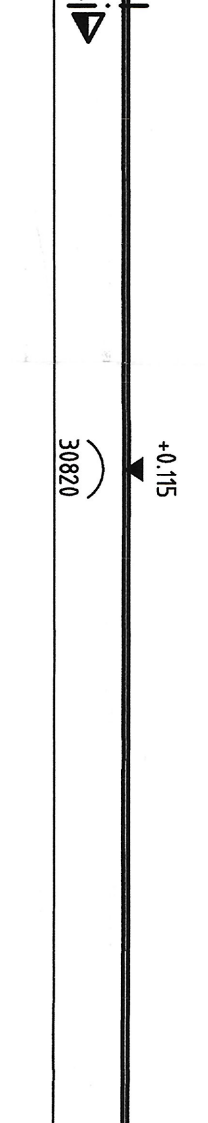

Dźwigar po wyjęciu - bez strzałki podniesienia

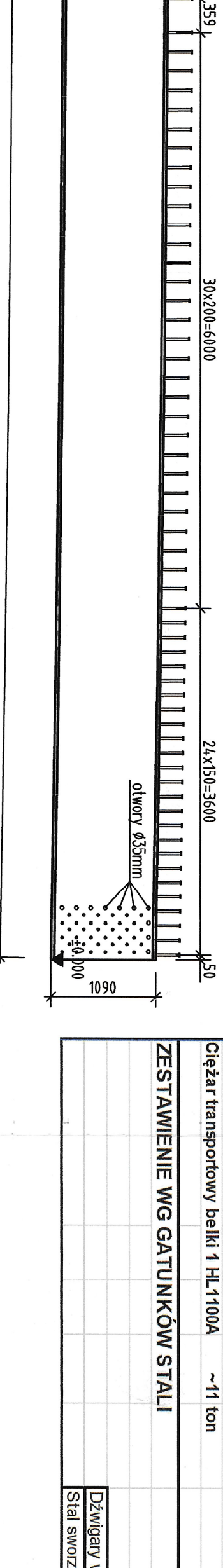
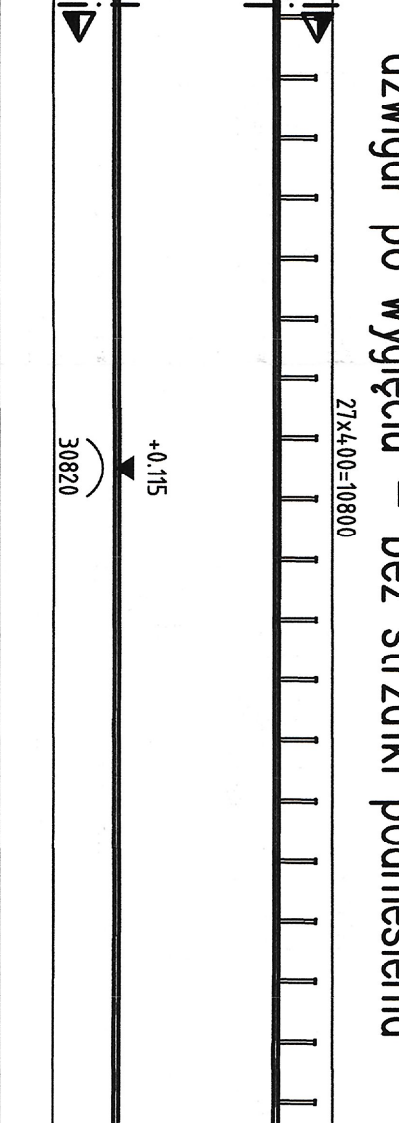

Dźwigar po wyjęciu - bez strzałki podniesienia

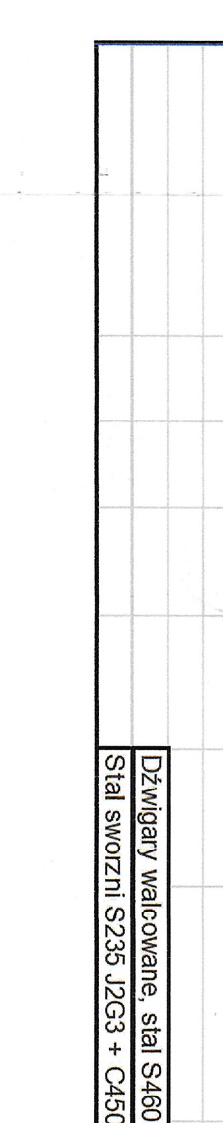

Project information and company details. Includes logos for 'BUDOWA ULICY STRZELECKIEGO W PRUSZCZU GDANSKIM', 'PROJEKT WYKONAWCZY', and 'Konspektyczna budowa'. It also lists the project name 'Most M3 nad Kanałem Raduni' and the project number 'M3-5.2'.