

1 szt.1 1:10

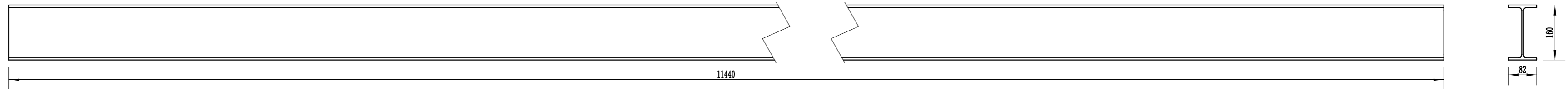

2 szt.2 1:10

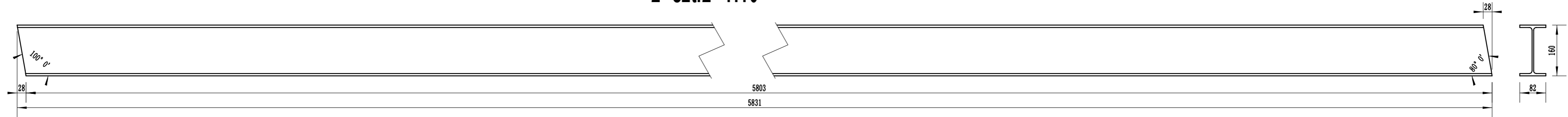

3 szt.2 1:10

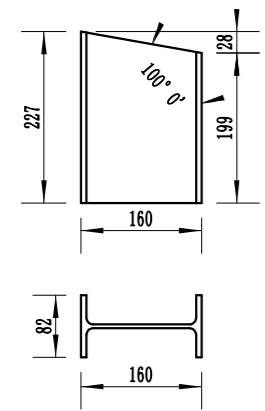

4 szt.2 1:10

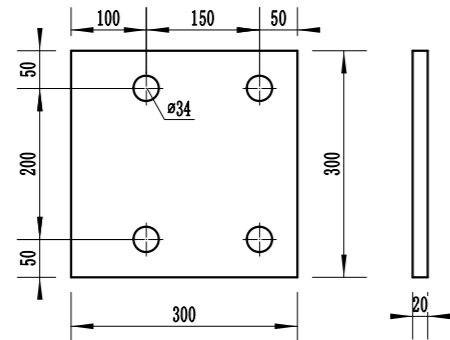

5 szt.2 1:10

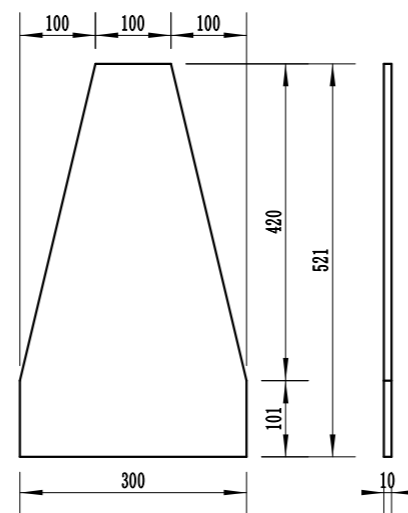

6 szt.38 1:10

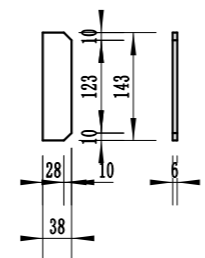

7 szt.16 1:10

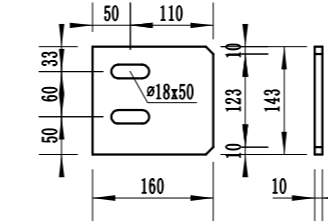

8 szt.1 1:10

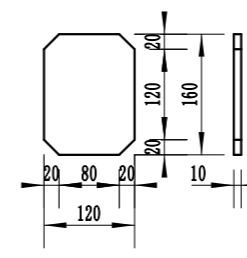

9 szt.1 1:10

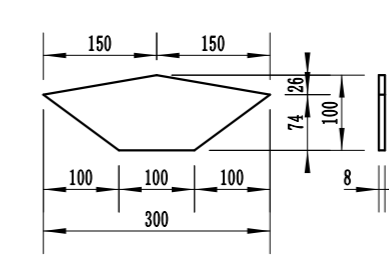

10 szt.1 1:10

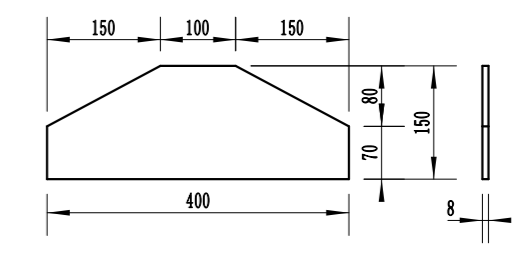

11 szt.8 1:10

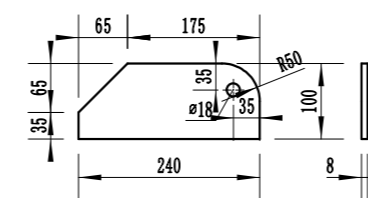

12 szt.8 1:10

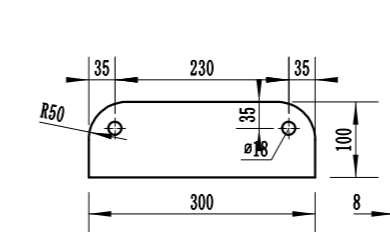

15 szt.1 1:10

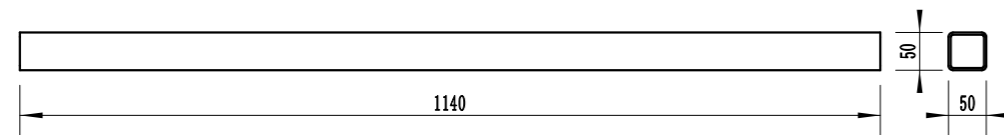

16 szt.2 1:10

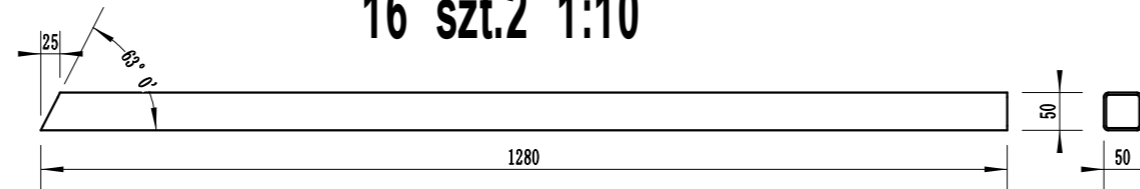

17 szt.2 1:10

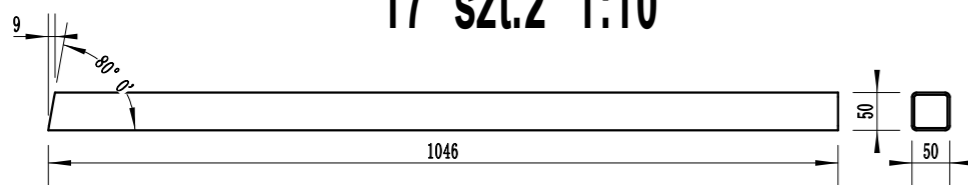

18 szt.2 1:10

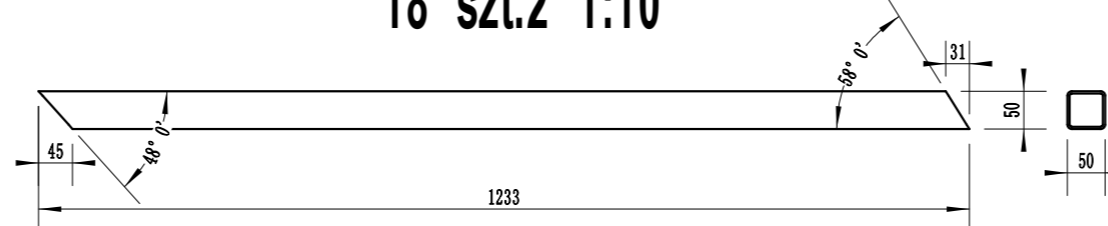

19 szt.2 1:10

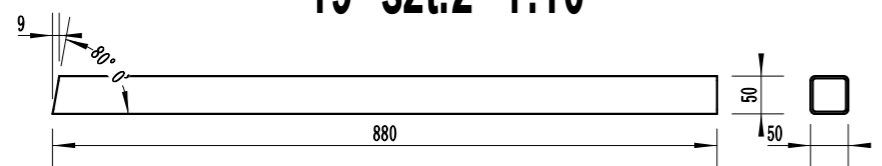

20 szt.2 1:10

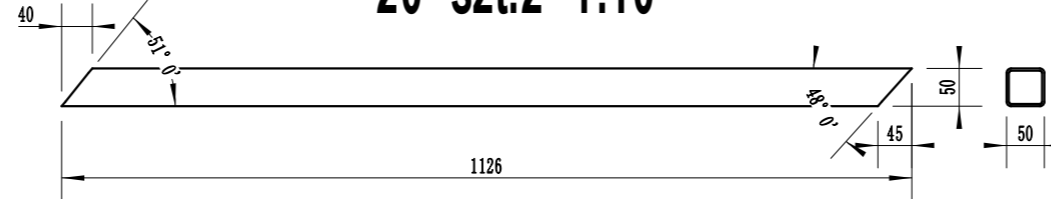

21 szt.2 1:10

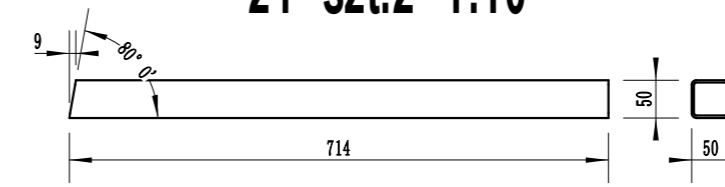

22 szt.2 1:10

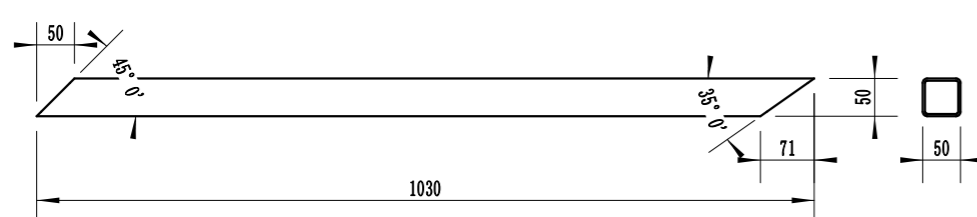

23 szt.2 1:10

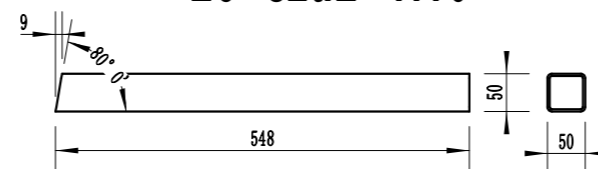

24 szt.2 1:10

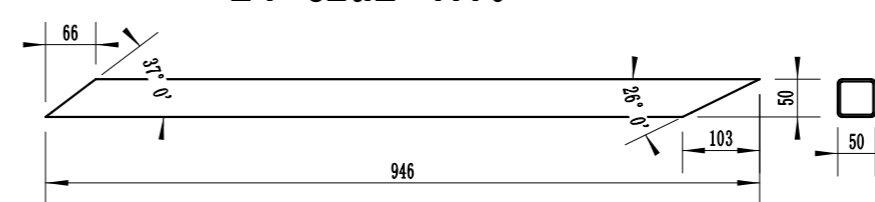

25 szt.2 1:10

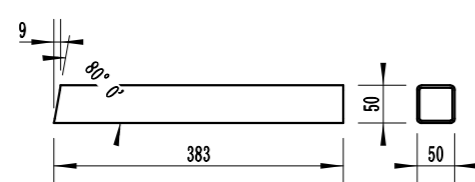

26 szt.2 1:10

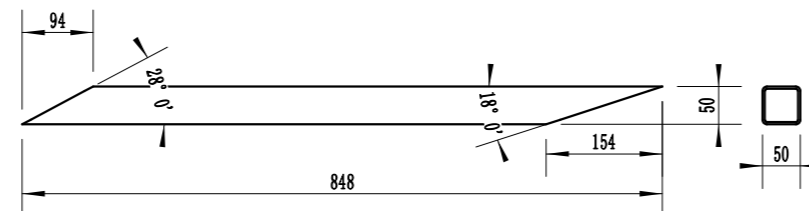

Stal profilowa:
S355JR wg. PN-EN 10025-2:2004
(wyrobu walcowane na gorąco ze stali konstrukcyjnych)

Numer	Nazwa	Ilość	Materiał	Poj.	Całk.
				Masa kg	
1	IPE 160 L=11440	1	S355JR	179.28	179.28
2	IPE 160 L=5831	2	S355JR	90.94	90.94
3	IPE 160 L=227	2	S355JR	3.34	3.34
4	Bl. 20x300x300	2	S355JR	13.47	13.47
5	Bl. 10x300x521	2	S355JR	8.92	8.92
6	Bl. 6x38x143	38	S355JR	0.25	0.25
7	Bl. 10x143x160	16	S355JR	1.65	1.65
8	Bl. 10x160x160	1	S355JR	1.44	1.44
9	Bl. 8x100x300	1	S355JR	1.17	
10	Bl. 8x150x400	1	S355JR	3.00	3.00
11	Bl. 8x100x240	8	S355JR	1.32	1.32
12	Bl. 8x100x300	8	S355JR	1.77	
15	Rk. 50x50x3 L=1140	1	S355JR	4.81	4.81
16	Rk. 50x50x3 L=1280	2	S355JR	5.35	5.35
17	Rk. 50x50x3 L=1046	2	S355JR	4.39	4.39
18	Rk. 50x50x3 L=1233	2	S355JR	5.04	5.04
19	Rk. 50x50x3 L=880	2	S355JR	3.69	3.69
20	Rk. 50x50x3 L=1126	2	S355JR	4.57	4.57
21	Rk. 50x50x3 L=714	2	S355JR	2.99	2.99
22	Rk. 50x50x3 L=1030	2	S355JR	4.09	4.09
23	Rk. 50x50x3 L=548	2	S355JR	2.29	2.29
24	Rk. 50x50x3 L=946	2	S355JR	3.63	3.63
25	Rk. 50x50x3 L=383	2	S355JR	1.60	1.60
26	Rk. 50x50x3 L=848	2	S355JR	3.05	3.05

Jednostka projektowa:		Pracownia Projektowa mgr inż. Hubert Reda	
		Nowy Bazanów 72, 08 - 500 Ryki tel. 605-539-040 e-mail: hr-projekt@wp.pl	
Lokalizacja: dz. nr. 3779 jedn. ewid. 061406_2 Kurów obr. 061406_2.0009 Kurów			
Temat:	BUDOWA WARSZTATU SAMOCHODOWEGO	Temat nr projektu:	2021/11
Tytuł:	Zespół4	Stadium:	PW
Projektant:	mgr inż. Hubert Reda upr. nr LUB/0374/PWBKb/15		
Sprawdzający:	mgr inż. Piotr Ścibior upr. nr LUB/0102/POOK/14		
Data:	09.08.2019	Branża:	konstrukcja
		Skala:	1:10
		Nr.rys/rew:	K-3/0